

12 HDB/PT Easy Loader Series 12 Ton Tag - Electric Brake

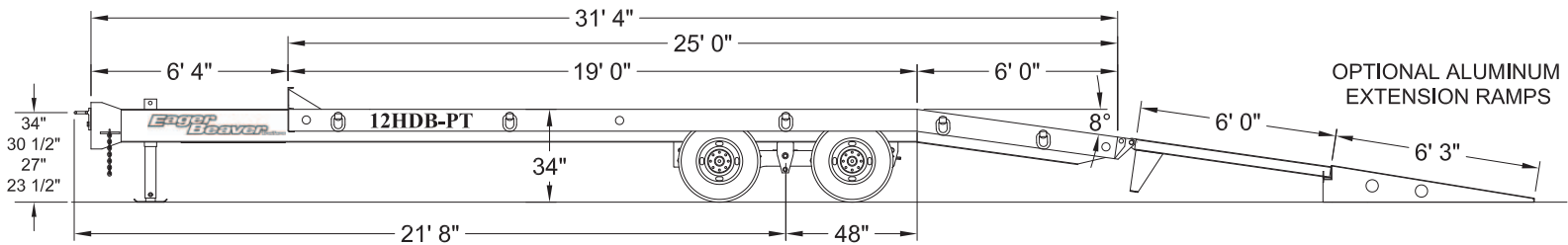

SPECIFICATIONS

Capacity: 24,000 lbs. **Trailer Weight:** 6,450 lbs.

Deck Width	8 ft. 6 in. Length: 19 ft. Height: 34 in.
Frame	Mainrails: W12" x 16 lbs. wide flange I-Beam, one piece cold formed Hi-tensile 50,000 P.S.I. steel mainrails from front to drawbar to rear of trailer 8° Beaver Tail (Safe Low Loading Angle)
Crossmembers	6" x 3.7 lbs. per ft. I-Beam pierced through mainbeam
Decking	Nominal 2" Hardwood
Headboard	8" high, full width of trailer Drawbar Storage Area
Lights	12 volt L.E.D., DOT approved
Wiring Harness	USA Star PLUS Sealed Modular Wiring Harness w/ 7-Way ATA Plug
Hitch	One piece solid cast steel (adjustable) lunette eye & flange mount
Safety Chains	Two 3/8" Blue-Krome plated high test, safety hook w/ latch
Parking Jack	12,000 lbs. static / 10,000 lbs. lift (Heavy Duty drop leg screw type)
Tie Down	Five per side - Patented "ROTO RINGS"® Swivel 360°
Colors	Black, Yellow, Blue (standard)

RUNNING GEAR

Tires	Eight 235/80R16 (E) Steel Belted Radial
Hubs/Wheels	Four 8 Stud on 6 1/2" BC (2 pc hub & drum), Eight 6.00 x 16 Disc Type Wheels, Oil seals
Suspension	3" wide rubber bushed Slipper Spring w/ equalizer, capacity 24,000 lbs. tandem (Adj. Alignment)
Axles	Two Heavy Duty Dexter, 12,000 lbs. each
Brakes	12 1/4" x 5" Electric
Break-away	12 Volt, wet cell battery with integrated battery charging system

OPTIONS

Additional Deck Length & Width (20'-21'-22'-23'-24' Optional Lengths) Additional "ROTO-RINGS"®
 Tool Box Lid (Lockable) Optional: Expanded Metal Tray Plate
 Spare Tire & Disc Wheel 235/80R16 (E) Optional: Spare Tire Carrier
 Traction 2" x 2" Angle 6" C/C Wheel Paths Optional: Traction Center Section, Bucket Pocket or Plate
 Ramps Wood (standard) Ladder (Optional N/C) Extension Ramps T-6 Alum. 22" x 75" 8° angle (SET)
 Brake controller: Cab mounted w/ complete truck wiring harness and receptacle
 Parking Jack Optional: 2-Speed Jack Optional: Jack mounted on Headboard
 Optional: 2-Speed Landing Gear is Available
 Apitong Decking in lieu of Oak
 Paint (other than standard Black, Yellow, Blue) Price on Request



Call (800) 257-8163 for more information